

## SPECIFICATIONS



### Features/Benefits

- Ceramic Disc Cartridge
- 16 11/16" High Swivel Spout, 7 13/16" Spout Length
- 2 Function Spray/Aerated Stream
- SnapBack® retraction system with Grip Lock™ weight
- 8" Deck Plate DA607750 Sold Separately for 3-Hole Applications
- 1.75 gpm (6.6 L/min) Max @ 60 psi

### Available Color/Finishes

| Color   | Description |
|---|-------------|
|                              | Chrome      |
| Please see danze.com or current price list for available finishes.<br>Finish is defined by additional suffix. |             |

### Standards & Certifications

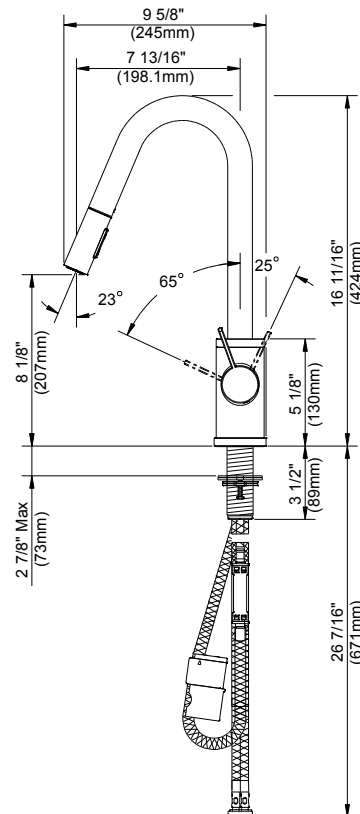
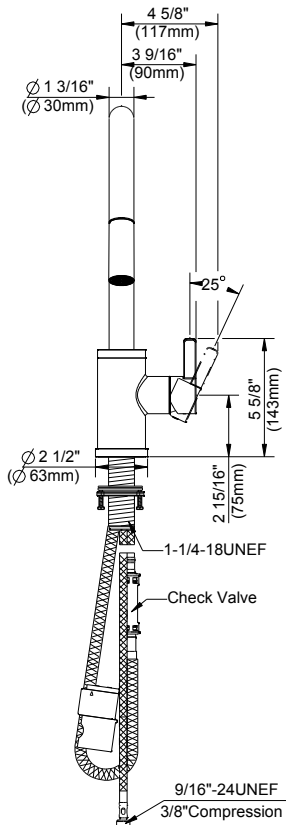

### Submittal Information:

Name: \_\_\_\_\_  
Location: \_\_\_\_\_

Contractor: \_\_\_\_\_  
Contact #: \_\_\_\_\_