

PRO-FIT® WHIRLPOOL & BATHTUB

3260 TFS 59 3/4" x 31 3/4" x 20 1/2"

Model number: 6153/6653 LH, 6154/6654 RH

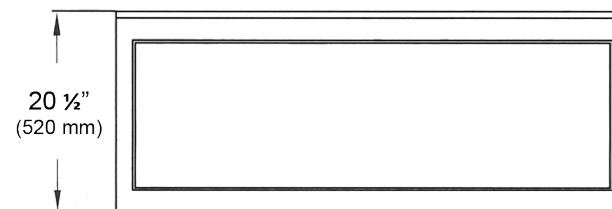
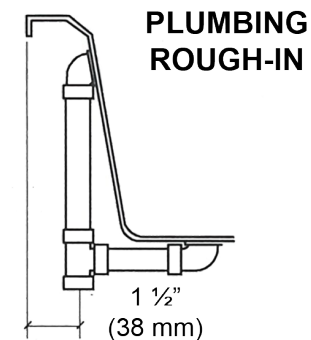
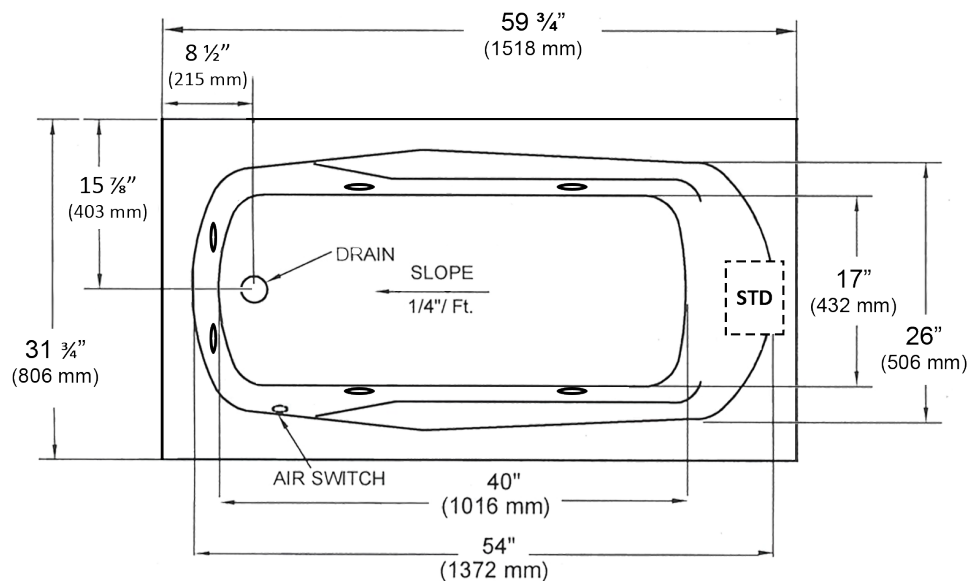

OPTIONAL REMOVABLE ACCESS PANEL
OPENING DIMENSIONS 54" x 11"

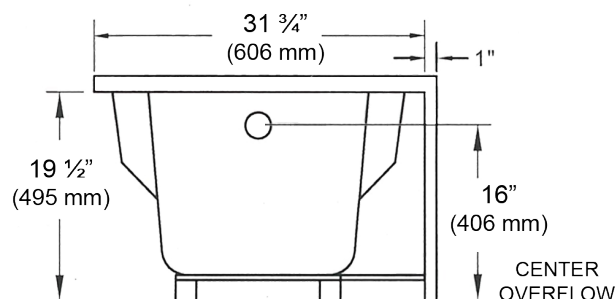

NOTES:

1. Pump location shown for clarity.
2. Required pump/motor access is 20" W x 15" H.
3. Measurements may vary 1/4" (+/-).
4. Apron is integral with optional removable access panel for access to pump/motor.
6. Specify LH or RH drain when ordering.

SPECIFICATIONS:

Dimensions:	59 3/4" x 32" x 20 1/2"	Number of jets:	6
Material:	Acrylic, fiberglass reinforced	Weight:	90 lbs. (41 kg)
Pump Motor:	120 V, 60 HZ, 6.0 Amp, Single Speed, Premounted	Water Capacity:	42 gals max., 27 gals min. 160 liters/103 liters)
Electrical Requirements:	120 V, 15 Amp, GFCI Protected	Floor Loading:	47 lbs./sq.ft. (229 kg/m ²)
On/Off Control:	Air Switch	Shipping Weight:	134 lbs. (70 kg)