

WARNING

1. Use this product only one person at a time.
2. Do not use this product unless all bolts screws and knobs are securely tightened.
3. Check that all bolts screws and knobs are tight every three months or as needed.
4. Do not overturn back tilt knob when decreasing tension.
5. Dispose of packing material properly. Do not use plastic cover as head covering. It may cause suffocation.
6. Do not use product as a stepladder.
7. Use this product for its intended purpose only.
8. Use mild detergent only for cleaning.

OSP FURNITURE LIMITED PRODUCT WARRANTY

Design Lab Products

- 3 years on gaming desks and chairs
- Upholstery is not warranted against routine scratching and scuffing

**All warranties are limited to the original purchaser for normal commercial usage defined as a standard forty hour work week by persons weighing 250 lbs. or less. This warranty will not cover labor, freight or damage from misuse, abuse, negligence, alteration, accident, vandalism, rusting, acts of nature or any other event beyond the control of Office Star Products. The warranty does not cover cosmetic damage that may result from normal use. Liability for incidental or consequential damages is excluded. The user assumes all risk of injury resulting from use of this product. When usage is more than 40 hours per week, a two year warranty on all parts applies. Fabric and foam is warranted for one year. This warranty gives you specific legal rights, and you may also have other rights which vary from state to state.*

It is the customer's responsibility to prepay freight on any components returned to the factory. Return freight on components covered by warranty will be paid by Office Star Products.

Our quality standards are among the highest in the industry. Sometimes, no matter how hard we try, there are times when parts are damaged or missing. Our Parts Department will do everything possible to promptly remedy the problem. Contact us via e-mail **parts@officestar.net**, by Fax 1-909-930-5629, or toll free parts number 1-800-950-7262, Monday through Friday 8:00 a.m. - 5:00 p.m. Pacific Time.

GLI25
GLITCH BATTLESTATION GAMING DESK
ASSEMBLY INSTRUCTIONS

STEP 1

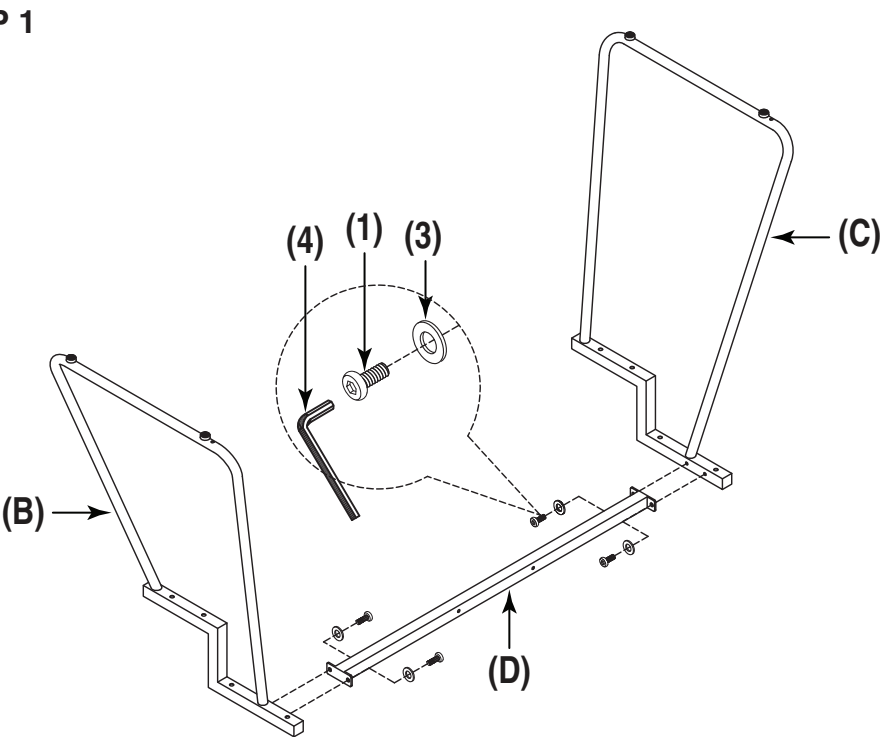

PART	QTY
A. Top	1
B. Left Frame	1
C. Right Frame	1
D. Cross Bar	1
E. Left Support Bar	1
F. Right Support Bar	1

HARDWARE	QTY
1. Short Bolt	8 + 1 EXTRA
2. Long Bolt	8 + 1 EXTRA
3. Flat Washer	16 + 2 EXTRA
4. Allen Wrench	1
5. USB & LED Power Supply Set	1

STEP 2

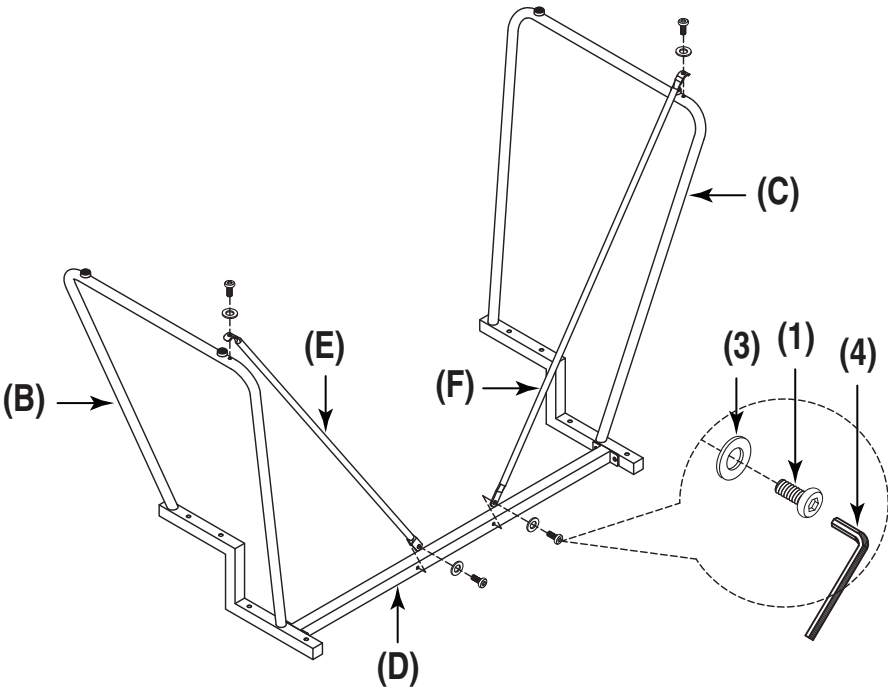

Remove all the parts from carton, separate them into part numbers indicated on the list and make sure part quantities are correct.
STEP 1 Attach Left & Right Frames (B & C) to Cross Bar (D) using two Flat Washers (3) and two Short Bolts (1) for each Frame.
DO NOT FULLY TIGHTEN BOLTS.
STEP 2 Attach Left & Right Support Bars (E & F) to assembly using two Flat Washers (3) and two Short Bolts (1) for each Support Bar.
FULLY ALL SHORT BOLTS (1).

GLI25
GLITCH BATTLESTATION GAMING DESK
ASSEMBLY INSTRUCTIONS

STEP 3

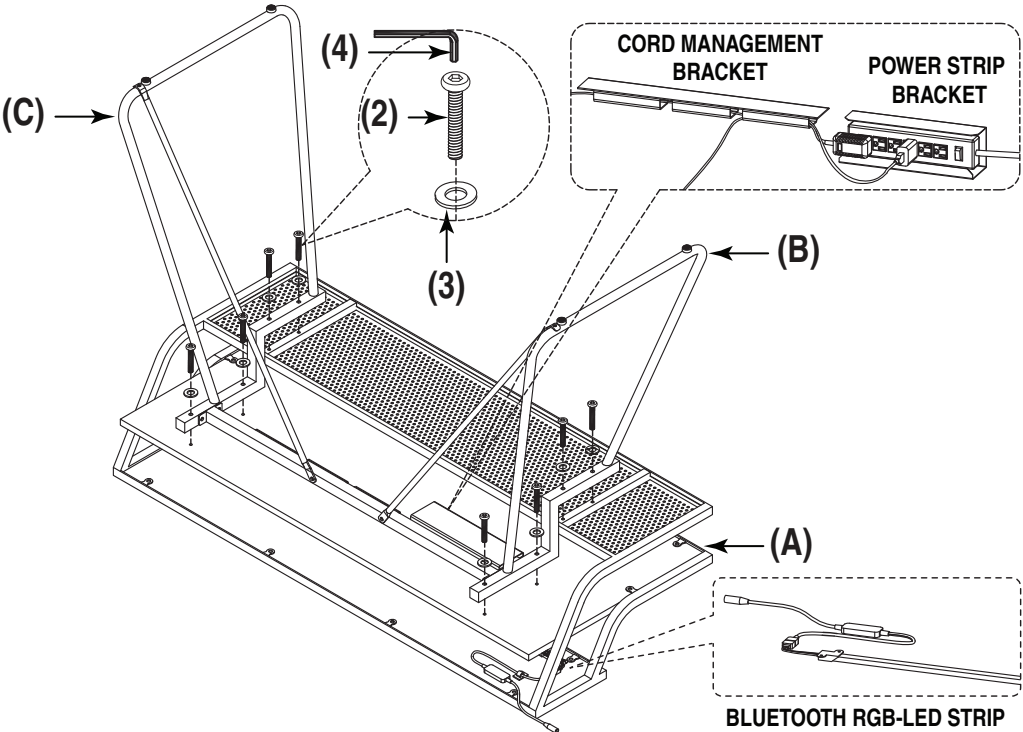

STEP 4

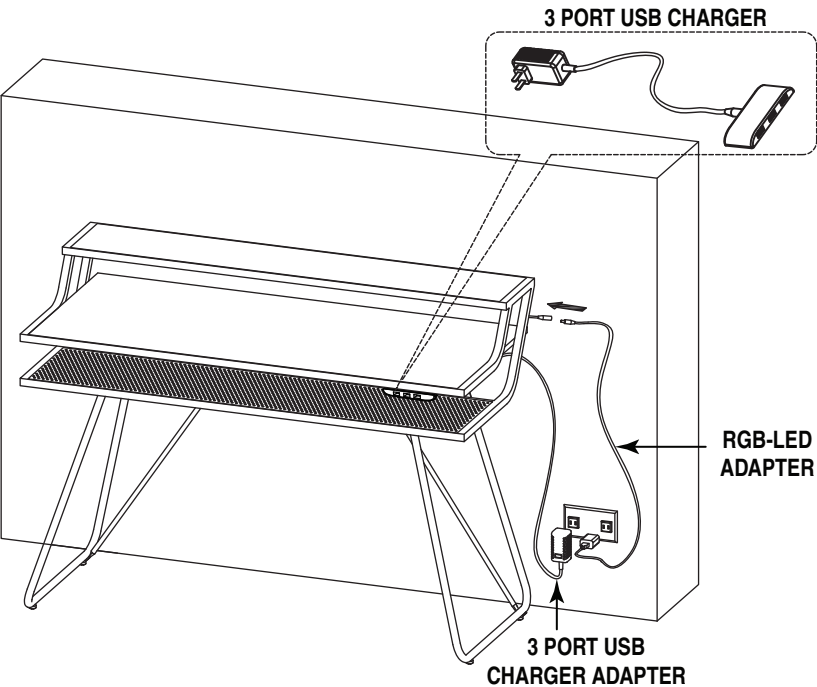

STEP 3 Secure Top (A) to assembly using eight Flat Washers (3) and eight Long Bolts (2). **FULLY TIGHTEN ALL LONG BOLTS (2).**
STEP 4 Connect USB & LED Power Supplies to USB & LED cables on desk.
ATTENTION: MAKE SURE ALL BOLTS ARE FULLY TIGHTENED BEFORE USING PRODUCT.

BLUETOOTH LED-RGB INSTRUCTIONS

STEP 1

Scan QR Code or go to your app store and download the duoCo Strip app.

STEP 2

Start the app and select the menu at the top left of the app.

STEP 3

Select “My Devices” and your device name will show below. Make sure the link icon is not broken next to the device name. If it is then just select the device name and refresh until the link icon shows a solid link.



STEP 4

Select the menu again to return to the “Adjust” screen and toggle the ON/OFF switch to turn on the LED lights.

STEP 5

Select the settings icon in the top right and select “Guide” for more detailed instructions.

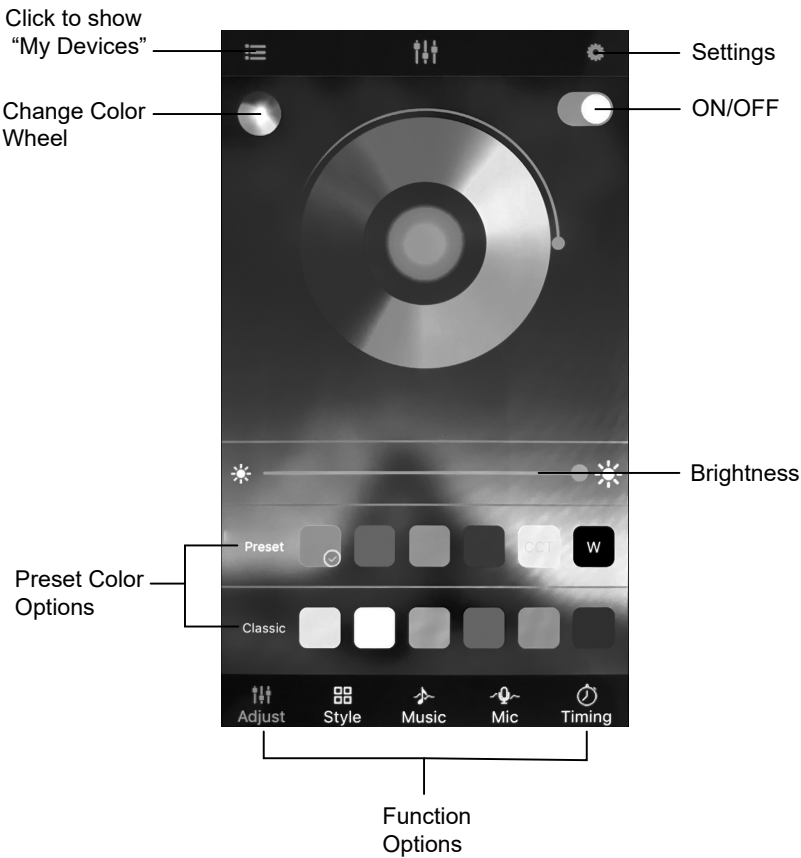

Product Specifications
Bluetooth: BLE V4.2
Input Voltage: 4.5 - 26V
Working Temp: -25C to 75C
Size: 43mm x 22mm x 11mm
Weight: 30g
Max Power: 144W(24V)

FCC INSTRUCTIONS

NOTE: This equipment has been tested and found to comply with the limits for a Class B digital device, pursuant to Part 15 of the FCC Rules. These limits are designed to provide reasonable protection against harmful interference in a residential installation. This equipment generates, uses and can radiate radio frequency energy and, if not installed and used in accordance with the instructions, may cause harmful interference to radio communications. However, there is no guarantee that interference will not occur in a particular installation. If this equipment does cause harmful interference to radio or television reception, which can be determined by turning the equipment off and on, the user is encouraged to try to correct the interference by one or more of the following measures:

- Reorient or relocate the receiving antenna.
- Increase the separation between the equipment and receiver.
- Connect the equipment into an outlet on a circuit different from that to which the receiver is connected.
- Consult the dealer or an experienced radio/TV technician for help.

-- This device complies with Part 15 of the FCC Rules. Operation is subject to the following two conditions: (1) This device may not cause harmful interference, and (2) this device must accept any interference received, including interference that may cause undesired operation.

-- Instructions shall caution users that modifications not approved by the party responsible for compliance could void user's authority to operate the equipment.